



SPECIFICATION:

MAX. CURRENT/VOLTAGE RATING WITH RESISTIVE LOAD:

400mA 32VAC-100mA 50VDC-125mA 125VAC

Metal bushing type: 500mA 48VAC - 200 mA 50VDC - 200mA 250VAC

INITIAL CONTACT RESISTANCE: 50mΩ max. (without wire leads)

INSULATION RESISTANCE: 1GΩ min.at 500VDC.

DIELECTRIC STRENGTH: 1,000 VAC rms.(initial value)

Metal bushing type: 1,500 VAC rms.(initial value)

ELECTRICAL LIFE AT FULL LOAD: 500,000 cycles.

OPERATING TEMPERATURE: -30°C to 85°C.

TOTAL TRAVEL: 1.5 mm(.059)

OPERATING FORCE: 2N~5N

CONTACT BOUNCE: 10 ms.

MECHANICAL LIFE: 1,000,000 cycles.

TORQUE: 0.5 Nm max.

Metal bushing type: 1.5 Nm max.

SOLDERING: 350°C max.for 5 seconds.

MATERIALS

CASE: Diallyl phthalate (DAP)(UL94v-0).

CAP: Polyamide 6/6.

BUSHING: Polyamide 6/6.

HOW TO ORDER

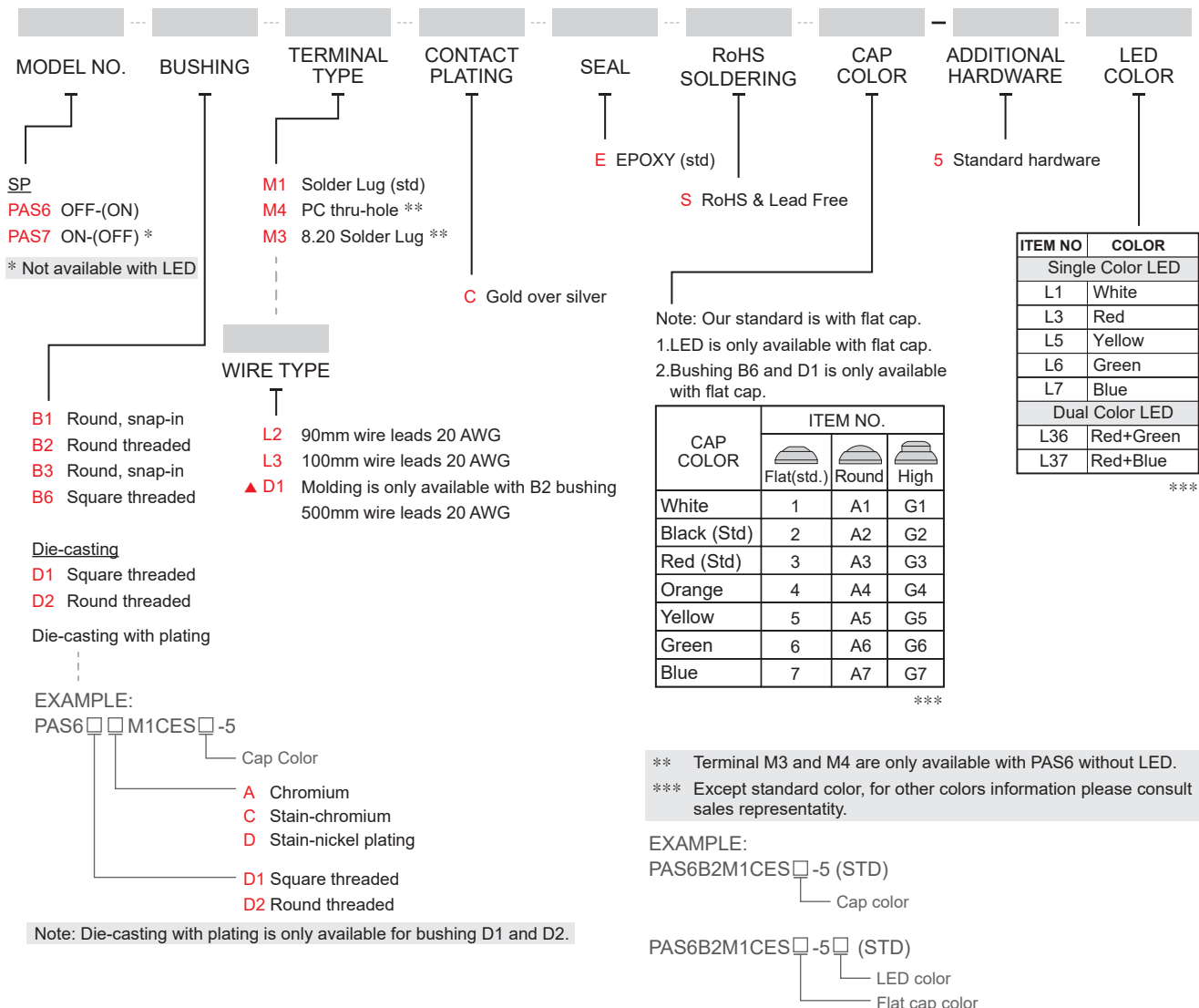

▼ SWITCH FUNCTION

NO. POLES	MODEL NO.	SWITCH FUNCTION		CONNECTED TERMINALS		
		POS.1	POS.2	POS.1	POS.2	SCHEMATIC
SP	PAS6	OFF	(ON)	OPEN	1-3	
SP	PAS7	ON	(OFF)	1-3	OPEN	

() = MOMENTARY

▼ BUSHING OPTIONS

B1 Round, Snap-in

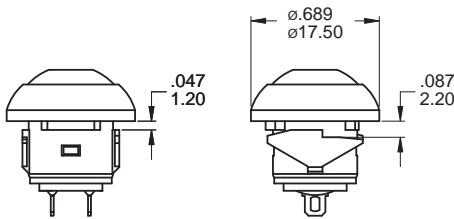

B2 Round threaded

D2 Round threaded, die-casting

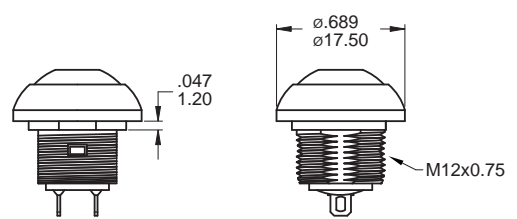

B3 Round, Snap-in

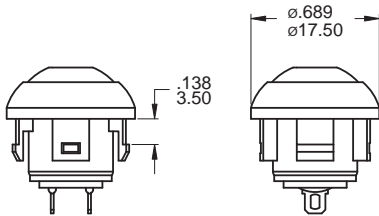

D1 Square threaded, die-casting

B6 Square threaded

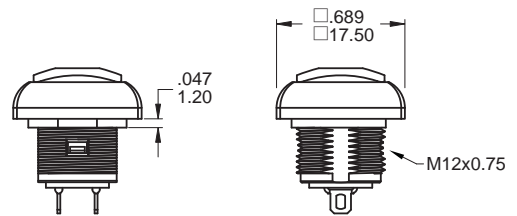

A Chromium

C Stain-chromium

D Stain-nickel

Note: Die-casting with plating is only available for bushing D1 and D2.



▼ TERMINAL OPTIONS

M1 Solder lug, STD

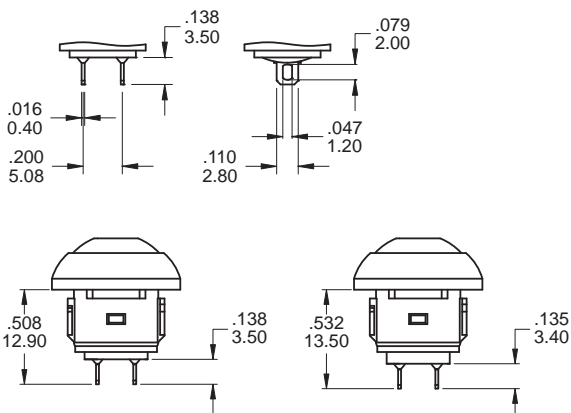

PAS6

PAS7

Note: Not available with LED

M3 Solder lug

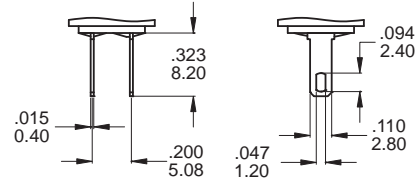

M4 PC Thru-hole

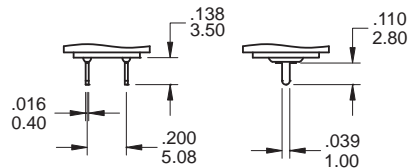

Note: Terminal M3 and M4 are only available with PAS6 without LED.



PA Series

Sub-Miniature Pushbutton Switches

IP 67
ACCORDING TO
EN 60529:1991+A1:2001
IEC 60529:2001



PA
Pushbutton Switches

▼ CAP OPTIONS

FLAT STD

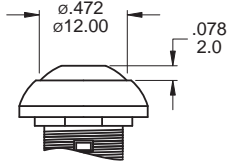

ROUND No LED *

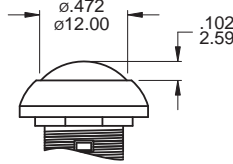

HIGH No LED *

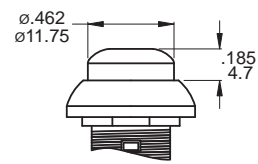

* Note: Round and high caps are not available for Square threaded bushing.

▼ PANEL MOUNTING

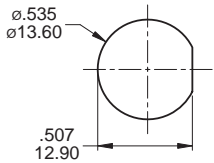

Panel thickness:
B1 bushing:
0.8 mm (.031inch) min. -1.8 mm (.071inch) max.
B2, B6, D1, D2 Bushing:
1.5 mm (.059inch) min. -4 mm (.157inch) max.

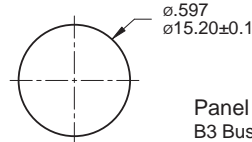

Panel thickness:
B3 Bushing:
2.85 +0.05/-0.10 mm (.112inch)

▼ DIMENSION

B1 Snap-in

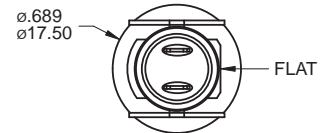
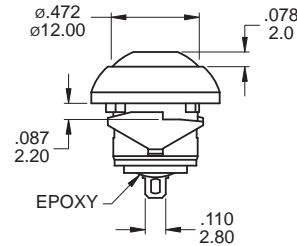
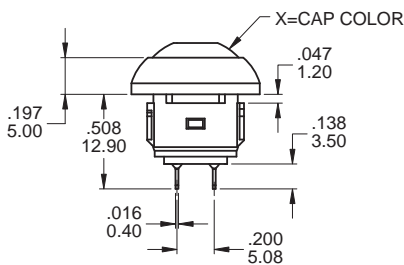

Bottom View

SPST

Model name. PAS6B1M1CESX-5

B2 Threaded

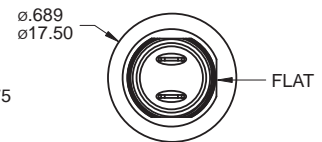
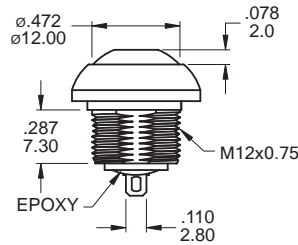
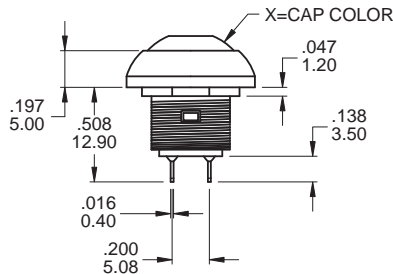

Bottom View

SPST

Model name. PAS6B2M1CESX-5

B3 Snap-in

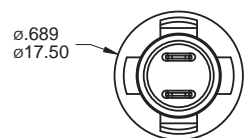
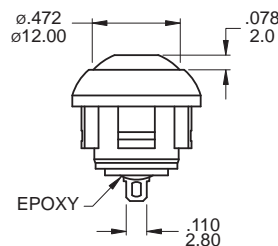
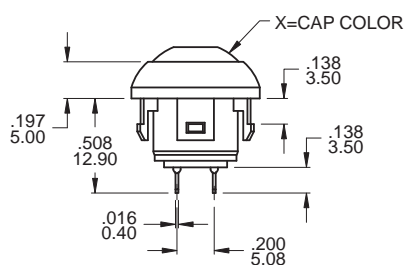

Bottom View

SPST

Model name. PAS6B3M1CESX-5

B6 Square threaded

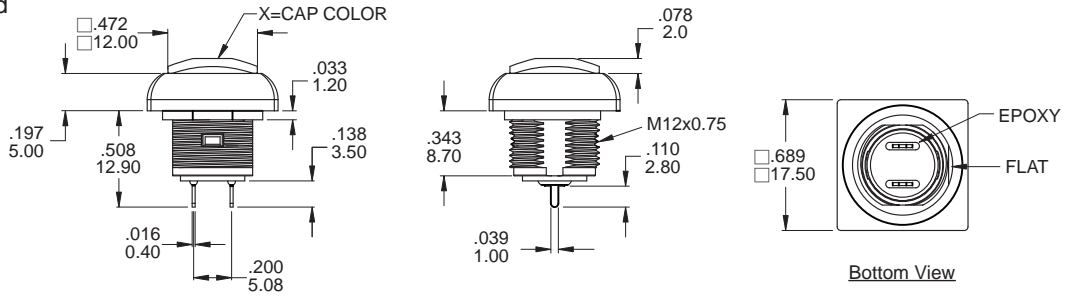

SPST

Model name. PAS6B6M1CESX-5

B2 Threaded

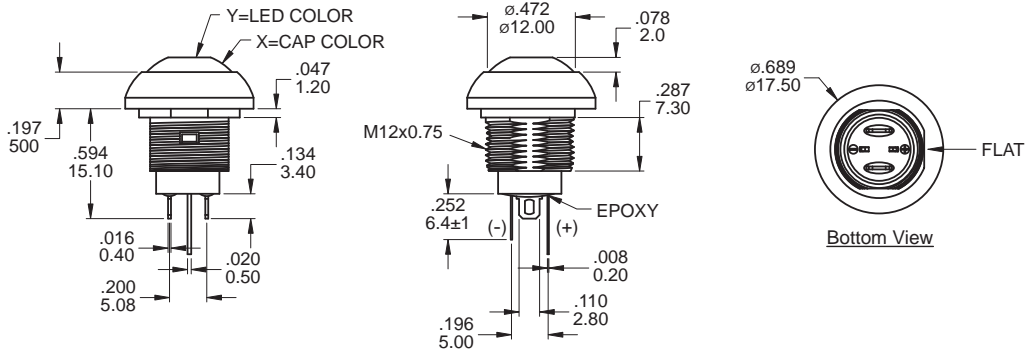

SPST

Model name. PAS6B2M1CESX-5LY

D1 Die-casting

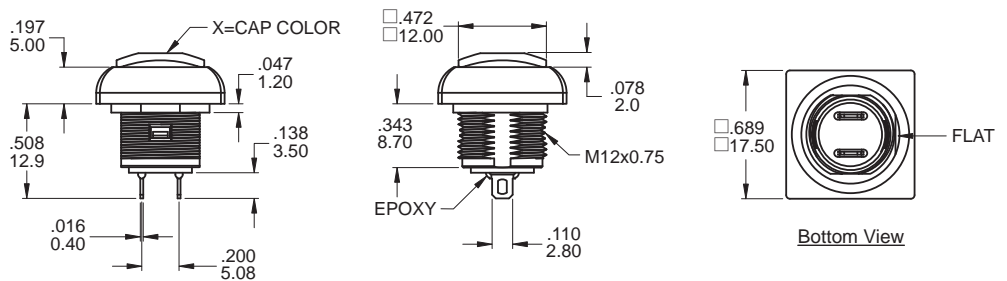

SPST

Model name. PAS6D1M1CESX-5

D2 Die-casting

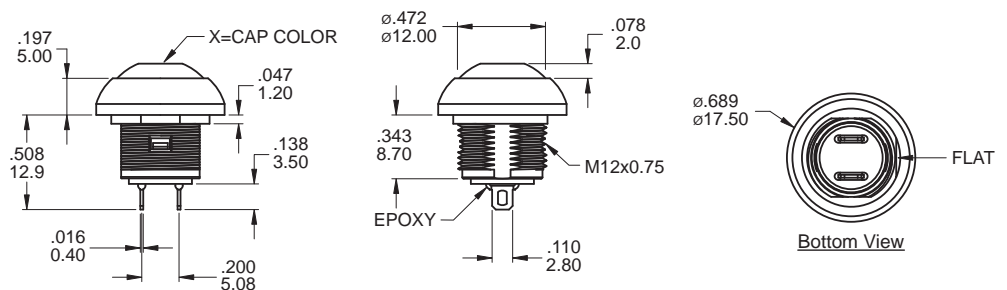

SPST

Model name. PAS6D2M1CESX-5



▼ WIRE OPTIONS

※ Please consult sales for additional wire options.

L2 90mm wire leads 20 AWG

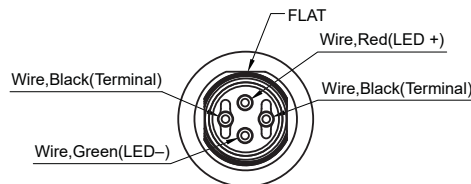
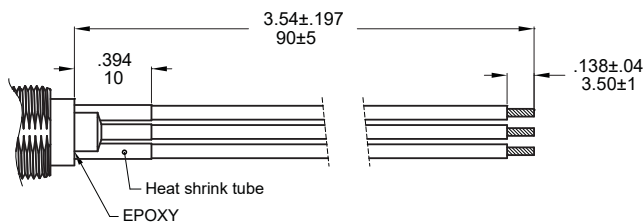

Note: No Illumination: Black Wire - Terminal

L3 100mm wire leads 20 AWG

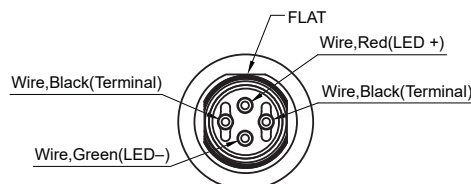
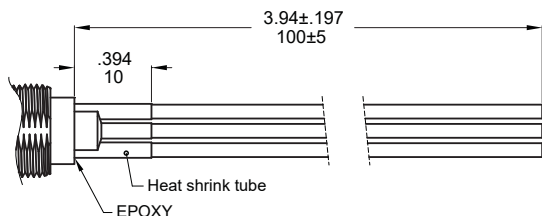

Note: No Illumination: Black Wire - Terminal

D1 Molding is only available with B2 bushing, 500mm wire leads 20 AWG

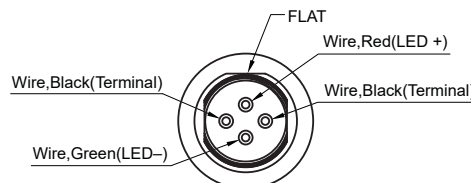
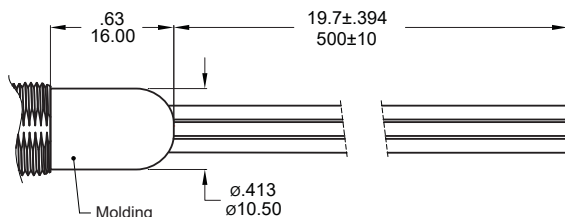

Note: No Illumination: Black Wire - Terminal

▼ HARDWARE

EXAMPLE: Model name. 5 Standard Hardware

* Standard for threaded bushing : 1 nut, 1 EVA washer or o-ring, 1 lockwasher
* For further information please consult sales representativity.

NUT (Std.)

Model name. MNU-PA03

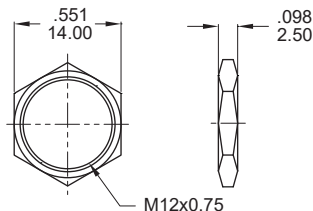

LOCK WASHER (Std.)

Model name. MNU-1M09

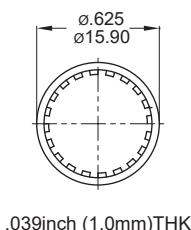

For Threaded bushing

EVA WASHER (Std.)

Model name. FSU-PA01

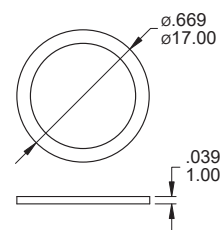

Available with bushing B1 and B2 only

O-RING (Std.)

Model name. FCP-A253

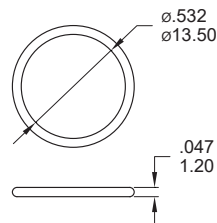

Available with bushing D1, D2 and B6 only

O-RING (Std.)

Model name. FCP-P004

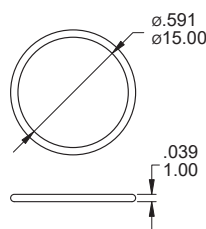

Available with bushing B3 only

NUT

Model name. MNU-PA04

MOQ: 10K

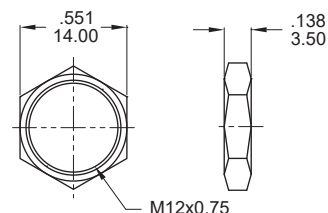



SPECIFICATION:

MAX. CURRENT/VOLTAGE RATING WITH RESISTIVE LOAD:

100mA 24VDC-life expectancy 200,000 cycles

2A 125VAC-life expectancy 10,000 cycles

INITIAL CONTACT RESISTANCE: 50mΩ max. (without wire leads)

INSULATION RESISTANCE: 1GΩ min.at 500VDC.

DIELECTRIC STRENGTH: 1,000 VAC rms.(initial value)

ELECTRICAL LIFE AT FULL LOAD: 200,000 cycles.

OPERATING TEMPERATURE: -30°C to 85°C.

TOTAL TRAVEL: 2.5 mm(.098)

OPERATING FORCE: 2N~5N

CONTACT BOUNCE: 10 ms.

MECHANICAL LIFE: 1,000,000 cycles.

TORQUE: 0.5 Nm max.

SOLDERING: 350°C max.for 5 seconds.

MATERIALS

CASE: Polyamide 6/6.

CAP: Polyamide 6/6.

BUSHING: Polyamide 6/6.

HOW TO ORDER

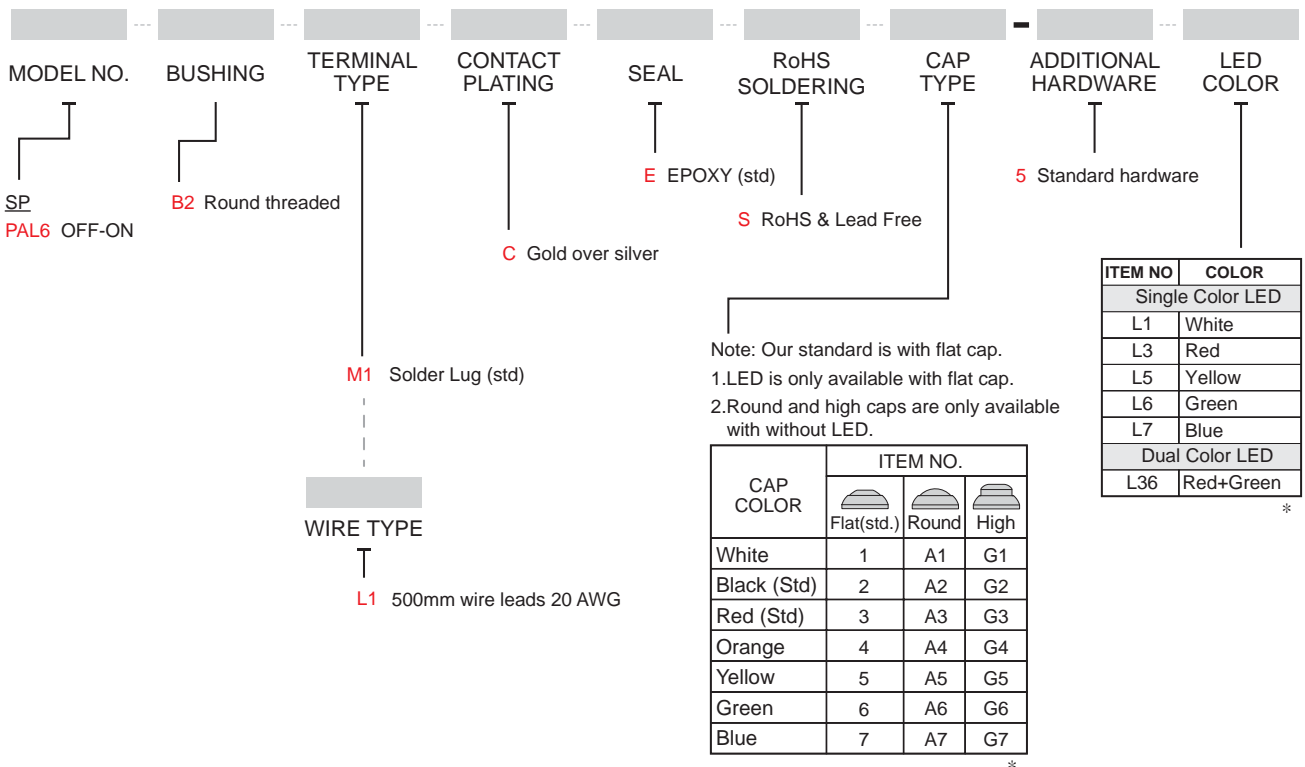

* Except standard color, for other colors information please consult sales representativity.

EXAMPLE:

PAL6B2M1CES□-5 (STD)

Cap type

PAL6B2M1CES□-5□ (STD)

LED color

Flat cap color



▼ SWITCH FUNCTION

NO. POLES	MODEL NO.	SWITCH FUNCTION		CONNECTED TERMINALS		SCHEMATIC
		POS.1	POS.2	POS.1	POS.2	
		SP	PAL6	OFF	ON	

▼ CAP OPTIONS

FLAT STD

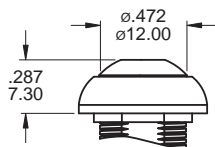

Without LED

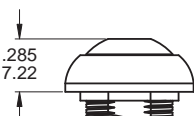

With LED

ROUND No LED *

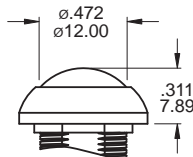

HIGH No LED *

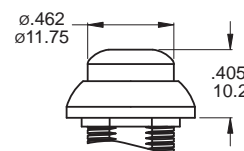

* Note: Round and high caps are not available for Square threaded bushing.

▼ DIMENSION

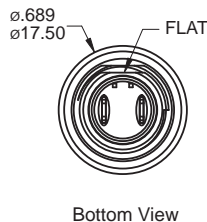
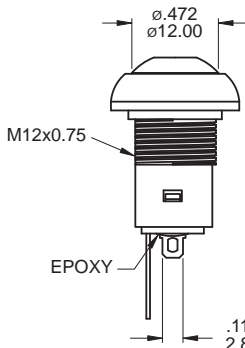
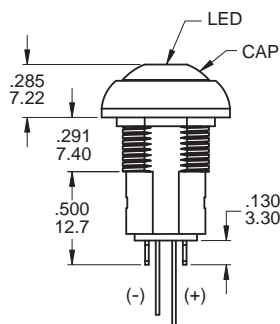

Bottom View

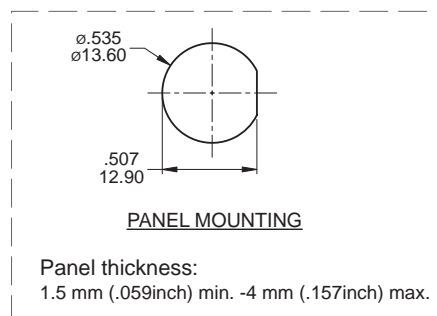

PANEL MOUNTING

Panel thickness:
1.5 mm (.059inch) min. -4 mm (.157inch) max.

▼ WIRE OPTIONS

Wire leads 20 AWG

* Please consult sales for additional wire options.

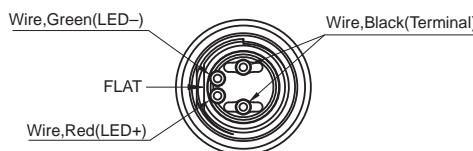
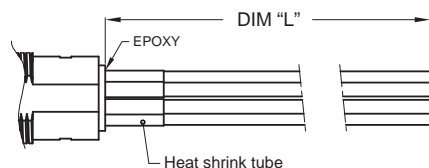

Note: No Illumination: Black Wire - Terminal

WIRE LENGTH

CODE	DIM "L"
L1	500±10(19.7±.394)
L2 *	90±5(3.54±.197)
L3	100±5(3.94±.197)

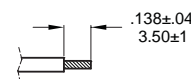

* Stripping wire for code L2

▼ HARDWARE

EXAMPLE: Model name. **5** Standard hardware

* Standard hardware : 1 nut, 1 O-ring, 1 lockwasher
* For further information please consult sales representativity.

NUT (Std.)

Model name. MNU-PA03

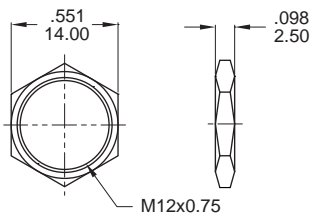

M12x0.75

LOCKWASHER (Std.)

Model name. MNU-1M09

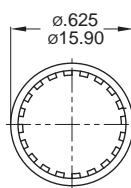

.039inch (1.0mm)THK

O-RING (Std.)

Model name. FCP-A253

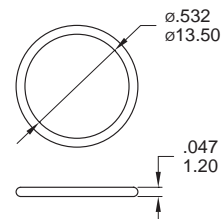

▼ RUBBER HOOD

Transparent rubber hood (Std.)

Model name. FCP-P003



Black rubber hood

Model name. FCP-P003-2

MOQ: 10K

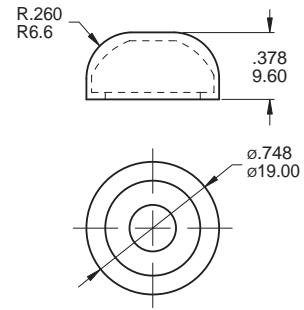

EXAMPLE: -
Model name.

4 Standard hardware+Transparen rubber hood

* Standard hardware : 1 nut, 1 EVA washer or o-ring, 1 lockwasher, 1 rubber hood

* For further information please consult sales representativity.

▼ SOLDERING PROCESS

MANUAL SOLDERING: Use 30 watts soldering iron and controlled the temperature at 350°.

Duration of solder immersion: Max. 5 sec.

WAVE SOLDERING: Recommend soldering temperature: 260 ± 5°C

Duration of solder immersion: Max. 5 sec. (PCB thickness is 1.6mm)

IP67 for the whole series:
Protected against the effects of
immersion up to 1 m water (30 min)

